

- ### HARD LANDSCAPE
- Asphalt Roadway**  
with In-situ concrete kerbs (to Engineers Specification)  
Main Spine Road - 6m width  
Remaining Road Network - 4.8m width with Flush Kerb
  - Raised Table**  
with In-situ concrete kerbs (to Engineers Specification)  
Granite Sett Ramps with HRA Chip Asphalt surfacing on Table
  - Footpaths:**  
In-situ concrete, Brushed Finish  
(to Engineers Specification)
  - Driveways**  
Permeable PC Concrete Pavers  
e.g. Tobermore Hydropave Tegula 240x120x80mm
  - Apartment Communal Area**  
Permeable PC Concrete Pavers  
e.g. Tobermore Hydropave Tegula 240x120x80mm
  - Rear Garden Terraces:**  
Permeable PC concrete Paving flags, 400 x 400mm  
e.g. Tobermore 'Mayfair' 40mm depth
  - Rear Gardens Paths:**  
Brushed Concrete  
(build-up to Engineers Specification)
  - Open Space Feature Paving:**  
Concrete Block Paving with Decorative Banding  
e.g. Tobermore Tegula 50mm depth
  - Natural Play Spaces (300sq.m):**  
Timber Play Equipment set in Bark Mulch  
surfacing. Equipment to detailed design stage.
  - Creche - Play Surface:**  
Wetpout Safety Surface
  - Bicycle Parking**  
Stainless Steel Sheffield Stand Type
  - Concrete Block Wall - Spine Walls -**  
2.0m high, Rendered and Capped, Colour: TBA  
(see Detail 01/D1 on 1706\_PL\_DD\_01)
  - Steel Bar Railings -** 1.2m high  
Galvanised & Powder Coated - Black  
(see Detail 03/D1 on 1706\_PL\_DD\_01)
  - Rear Garden Dividing Boundary -** 1.8m high  
Timber Panel Fence with Concrete Posts, Gates to  
match Fencing (see Detail 02/D1 on 1706\_PL\_DD\_01)
  - Site Boundary Fence -** 1.8m high  
Green Open Weldmesh Fencing  
Hand-augered posts to minimise impact on adjacent trees  
(see Detail 04/D1 on 1706\_PL\_DD\_01)
  - Site Boundary**



NOTES:  
1. This drawing is intended to show landscape architectural proposals only. Please refer to Architects and Engineers drawings for relevant details of buildings, structures, roads, parking, etc.  
2. The copyright of this drawing is vested with Murray & Associates. This drawing may not be copied or reproduced without written consent.  
3. All materials referred to on this drawing - including plant species - are indicative and subject to change following detailed site investigation. Significant changes, if any are required, will be referred to the relevant authority for agreement.  
4. This drawing is not suitable for use for construction purposes.  
5. Discrepancies to be referred to Murray & Associates for clarification.

Rev	Date	Revision	Drawn	Checked
0	21-02-19	Planning Issue	MT	JB

**murray & associates**  
landscape architecture  
16 The Selwyn Building  
44-45 Clontarf Road  
Dublin 3  
e: mail@murray-associates.com t: 01 854 0090

**Project Title:** Creagh Residential Development

**Client:** Strutec

**Sheet Title:** Neighbourhood Open Space

**Sheet No.:** 1706\_PL\_P\_03\_IFP

**Project Architect:** Strutec

**Scale:** 1/250 @ A1

**Date:** 21-02-19

**Revision:** 0

Copyright MURRAY and Associates, 2019

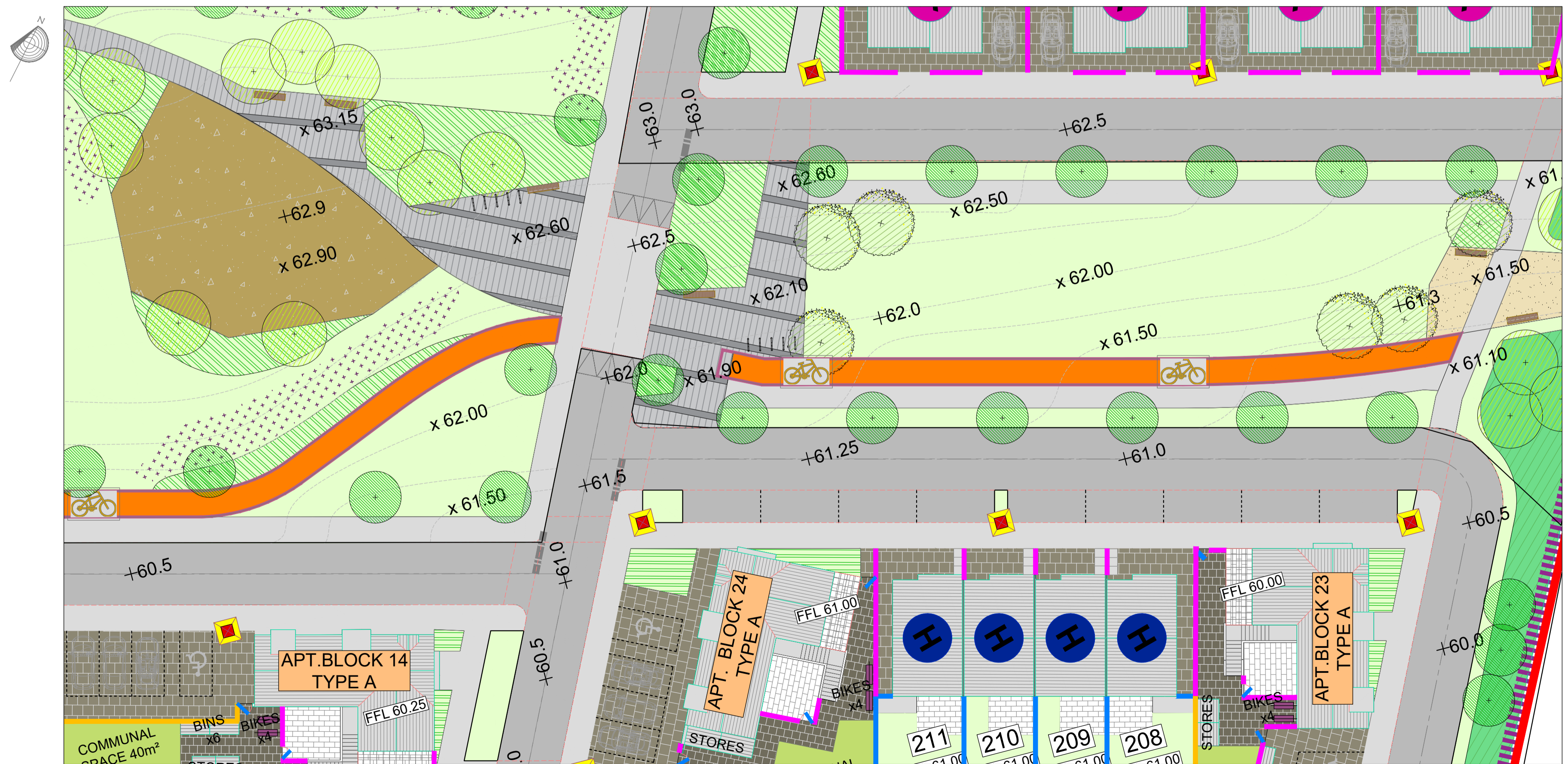

### SOFT LANDSCAPE

- Existing:**
- Tree**  
(see Tree Survey for Details: Dr 1706\_TS\_P\_01)
- Proposed Tree Planting:**
- Street Trees**  
R/B 14-16cm girth, 2m Clear Stem  
*Acer campestre* 'Elegant'  
*Acer platanoides* 'Columnare'
  - Linear Open Space Trees**  
R/B 14-16cm girth  
*Pyrus 'Chanticleer'*  
*Carpinus betulus* 'Frans Fontaine'
  - Open Space Trees**  
R/B 16-18cm girth  
*Prunus avium* 'Plena', *Betula pendula*, *Alnus glutinosa*, *Quercus robur*, *Sorbus aria*
  - Amenity Grass with Seasonal Bulbs**
  - Shrub Planting: Public Areas**  
Container Grown, P9 - 2ltr  
- to include the following species  
planted at approx 5no per sq.m. min  
*Lavandula 'Hidcote'*, *Sarcococca humilis*, *Carex oshimensis* 'Evergold', *Hypericum 'Hidcote'*, *Mahonia aquifolium*, *Rosmarinus officinalis*, *Lonicera pileata*, *Viburnum davidii*, *Prunus lusitanica*
  - Shrub Planting: Front Gardens**  
- Low Maintenance Planting to include Perennial & Fern selection, including planting from the above list of shrubs @ 5 per sq.m.
  - Garden Lawns:**  
- Coburns Greenlawn Grass Seed Mix  
200mm topsoil depth
  - Amenity Grass Lawn**  
- Coburns Utility/Play Grass Seed Mix  
200mm topsoil depth
  - New Mixed Native Hedgerow** (bare-root planting) - to include:  
Hawthorn (*Crataegus monogyna*), Blackthorn (*Prunus spinosa*), Holly (lex sp.) Guelder Rose (*Viburnum opulus*), Common Dogwood (*Cornus sanguinea*)
  - Grass Mounds**  
- 1m height maximum
  - Existing Hedge**  
- to be removed
  - Existing Hedge**  
- to be retained  
Selective pruning, clearance and enhancement as advised by Landscape Architect